



SINCE 1989

WWW.CATAMARANS.COM

WORLD'S LARGEST CATAMARAN SITE

# BAREBOAT CHARTER - Windancer IV - LAGOON 440 Nanny Cay Marina, Tortola, British Virgin Islands

**Dealer of...**



TomCat Boats

Charter Promotions

Beautiful Lagoon 440 with flybridge



SPACIOUS CABINS



LIGHT AND AIRY SALON



Phone: [1-800-262-0308](tel:1-800-262-0308) [Inquire >>](#)

### SAILING VACATION SEASONS AND RATES

	Dec 21- Jan 6 Jan 25 - April 7	Jan 7 - Jan 24 April 8 - May 19	May 20 - July 28 Oct 25 - Dec 20	July 29 - Oct 24
<b>Weekly</b>	\$7800	\$6800	\$5800	\$4800

\$30 per day fuel charge, \$420 maximum

### WHY PEOPLE LOVE THE LAGOON 440

A simple glance at the boat is enough to notice its main distinguishing characteristic: a rigid bimini, with an integral helm station. The helm station is surrounded by all the sail control lines, reefing included, so that one person can easily handle all the maneuvers. The galley features a large serving shelf extended towards the cockpit, a countertop surface worthy of one found in a house, and storage everywhere, including a big cookware locker. While the layout remains classic, the salon presents a space and shape studied carefully to associate practicality with ergonomics: the seats are more comfortable, access and movement is easy.

### MAIN FEATURES

3 queen cabins, 3 heads, 2 forepeak berths
A/C for additional fee
Year: 2004
Length: 44'8"
Beam: 25'2"
Draft: 4'3"
Engines: 2 x 56 Yanmar HP
Water: 240 gallons
Fuel: 170 gallons
Sail area: 1293sq.ft. cruising
Average Interior Headroom: 6'9"
Maximum amount of guests: 8 with option of 9th guest in salon for additional \$250

Tel: 1800-262-0308 Tel: (284)494-0410 [www.catamarans.com](http://www.catamarans.com)



SINCE 1989

WWW.CATAMARANS.COM

WORLD'S LARGEST CATAMARAN SITE

# BAREBOAT CHARTER - Windancer IV - LAGOON 440 Nanny Cay Marina, Tortola, British Virgin Islands

**Dealer of...**

Owners Version. Year 2004. Three queen size cabins and 3 heads/showers. Available British Virgin Islands, Tortola.

## Layout



TomCat Boats

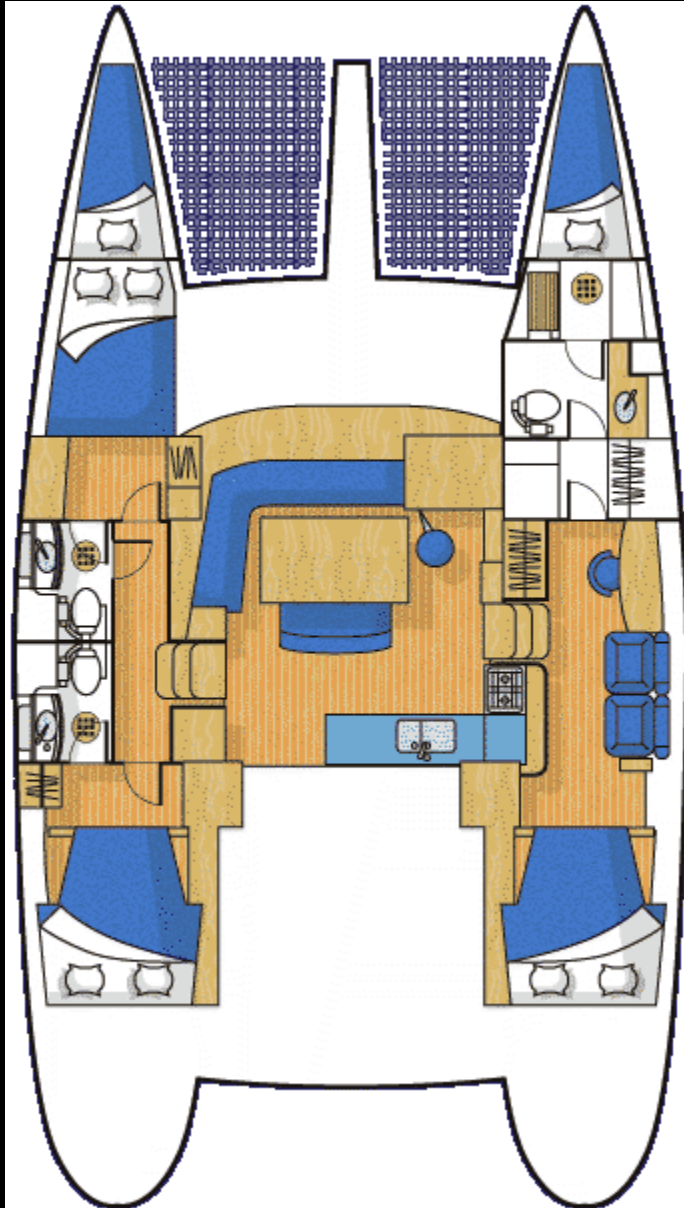

## Specs

### MAIN FEATURES

Model	Lagoon 440
Year	2004
Length	44'8"



Beam	25'2"
Draft	4'3"
Engines	2 x 56 HP Yanmar
Water	240 gallons
Fuel	170 gallons
Sail area	1293 sqft cruising
Average interior headroom	6'9"
Electrical:	110V US style outlets, 12V
Amount of guests	8 with option of 9th guest in salon for additional \$250
Additional Information:	A/C for additional fee

### Accommodations

Cabins	3 queens cabins
Berths	2 forepeak berths, Salon table converts into double berth
Forward port berths (queen beds)	6'7" x 5'2"
Aft port berths	6'7" x 5'2"
Owners starboard berth	6'7" x 5'2"
Heads	Three (3)
Fans	Yes, throughout.

### DECK GEAR

Aft cockpit floor in teak  
Pulpit with wooden seat  
Pair of off white sun lounge pads  
AFT off white cockpit seat cushions  
FWD off white cockpit cushions

### COCKPIT

Large cockpit functions as deck salon, protected by fixed composite bimini with cockpit lighting

- U-shape foredeck seating area
- Fixed varnished cockpit table accommodates 8 / 10 people, with protective cover
- Forward Deck built in seating area that accommodates 8 people.

### INSTRUMENTS

VHF Radio  
Chartplotter  
Wind/speed/depth gauges  
Autopilot  
Compass and hand held compass  
Binoculars  
Local Charts

### ELECTRICAL CIRCUIT

110V US style outlets, 12V  
1500w inverter

### HI-FI & ELECTRONICS

Radio/CD Changer Laser & 2 loudspeakers in salon  
Waterproof loudspeakers in cockpit  
wind, depth, speed, autopilot  
Rudder tiller at nav stat., VHF with double handset

### SALON

Large main salon with panoramic view – standing headroom approx: 6'9"

- Varnished coffee table that can be replaced by a large cockpit table
- Bench seating for 8/10 people
- Double settee with two back galley-side drawers
- Large locking aluminum sliding cockpit door
- Cabinet for TV/Hifi on port side aft
- 2 opening hatches on forward windows
- 2 opening deck hatches

### GALLEY

Galley in main salon to starboard with direct access to cockpit through sliding window

- Stainless steel countertop
- Microwave
- Toaster
- Double s/s sink with mixer tap
- Integrated dish drainage area.
- Storage under sink
- 3 burner stove / oven with grill (LPG)
- 12V fridge
- 12V freezer

## FLYBRIDGE

- Twin deck access stairways, one from each side
- Large bench seat for 6 people with beige PVC cushions
- Ergonomically-designed helm station with leathered wheel, engine throttles, engine panels, hour meters, fuel gauges, compass, plexiglass-protected chart storage, rope storage.
- Folding dark-blue canvas bimini on stainless steel frame over the helm post, with removable clear windscreen, and protective storage cover.

## CHARTER GEAR

CD Player, Linens/Towels (except beach towels), Snorkeling fins, First Aid Kit, Navigation and tool kit, Local charts, Head and Galley cleaning kit, Binoculars and life jackets, Fully equipped galley, Water & outboard gas/oil, Stanchion-mounted charcoal barbecue, Dinghy & outboard.

**The Catamaran Company is the world's largest exclusive retailer, reseller, operator, broker and charter operator of catamarans. Lagoon has honored The Catamaran Company as its best World Dealer and Power Catamaran distributor, confirming its international status as the #1 source of quality sailing and power catamarans in both Europe and North America for 2004, and sailing catamarans for 2005. Our Yacht Ownership Program also accepts any model built by any manufacturer and may have the vessel equipped to his particular specifications. Unlimited owner's time is permitted.**

Tel: 1800-262-0308 Tel: (284)494-0410 [www.catamarans.com](http://www.catamarans.com)